

An eco-friendly and
secure investment!

ctc
HEAT PUMPS

CTC EcoZenith i360

Ultra-efficient indoor module for plenty of hot water.

9-12 kW, models H and L

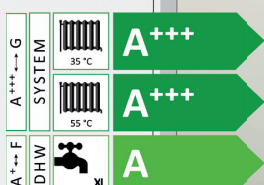
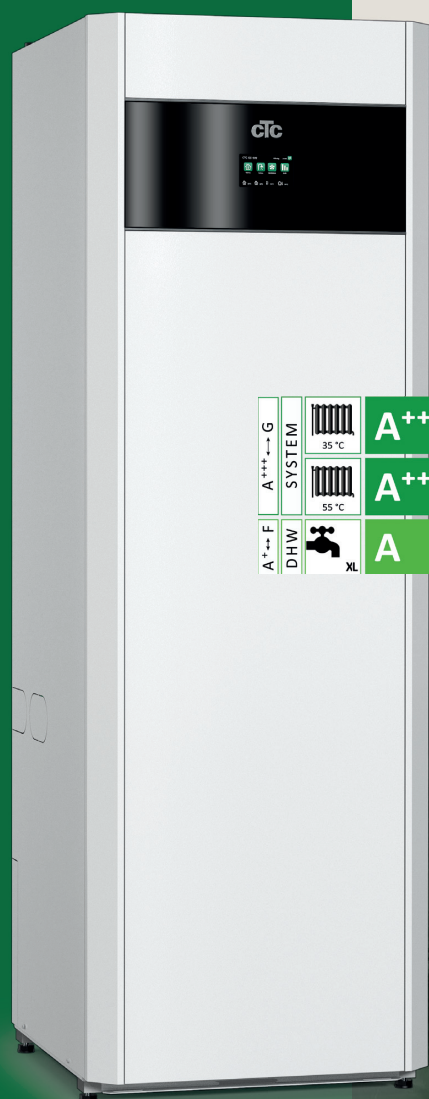

- Smart and user-friendly
- All-inclusive with minimal energy losses
- Low ceiling height? No problem!
- Climate-controlled and expandable
- Plenty of hot water

Find a CTC distributor in your country - www.ctc-heating.com



MADE IN SWEDEN

CTC EcoZenith i360 is equipped with an efficient flow-through DHW heater. When combined with CTC EcoAir or CTC EcoPart, it can produce over 300 litres of hot water.

A complete heat pump

CTC EcoZenith i360 has a stylish design, integrated display and high-quality finish! The design of your new indoor module allows it to become a stylish part of your interior, wherever you choose to install it.

With the integrated touch screen, CTC EcoZenith i360 has a user-friendly interface where you can easily access all functions and can both swipe and scroll, just like on your smartphone. In addition, you can easily mirror the display on your tablet, mobile, etc.

The colour touch screen has clear symbols and the option to switch languages, making it easy to adjust the heating and hot water or to retrieve a wealth of operating data.

CTC EcoZenith i360 is an ultra-efficient

indoor module with built-in heat pump control. Install it together with CTC EcoAir air-to-water heat pumps for the perfect combination. For those who would prefer ground source heating, CTC EcoPart is the ideal choice.

All-inclusive with minimal energy losses

The expansion tank, supply cable and primary flow sensor are all factory-fitted. In addition, the manometer and automatic bleeders come as standard. CTC EcoZenith i360 is well-insulated and therefore has minimal energy losses.

Low ceiling height? No problem!

Choose the height of the indoor module that suits your home. It is available in two heights: 1666 or 1924 mm. The low height model has pipe connections at the top while the taller model connects at the bottom.

Climate-controlled and expandable

The built-in shunt-automatics is climate-controlled and takes into account both internal and external temperatures. CTC EcoZenith i360 is able to control two individual heating systems as standard.

By using various accessories, you can easily add solar heating, or let a water-jacketed stove or your existing water boiler contribute heat. Or why not connect a pool so you can also enjoy the warmth in summer?

Smartgrid and ready for the future

CTC EcoZenith i360 has internet connectivity as standard so that you can easily control your product remotely using the myUplink app. It is also equipped to connect to Alexa, Google Home and the future power grid (SmartGrid).

| Technical data 400 V | | i360 H 3N~ | i360 L 3N~ |
|--|--------|------------------------------|------------------|
| CTC-no. | | 589401001 | 589400001 |
| Weight (packaged weight) | kg | 156 (185) | 145 (172) |
| Dimensions (depth x width x height) | mm | 673 x 596 x 1867 | 673 x 596 x 1669 |
| Required ceiling height | mm | 1928 | 1669 |
| Kv value – product (1Bar Δp) | | 2.7 | 2.6 |
| Sound power L _{WA} B0/W35 (EN 12102) | dB(A) | 15 | |
| Electrical data, connection | | 400V 3N~ 50Hz | |
| Rated power | kW | 12.2 | |
| Rated current (recommended fuse) | A | 19 (20) | |
| Max. immersion heater output at group fuse: 10/13/16/20/25 A | kW | 3.5 / 6.1 / 8.4 / 9.9 / 11.9 | |
| Ingress Protection class (IP) | | IP XI | |
| Output range immersion heater (min-max) | kW | 0.5 - 11.9 | |
| Max. operating pressure: Heating system (PS) | bar | 0.3/3.0 | |
| Max. operating pressure: DHW system | bar | 10 | |
| Water volume: Heating system (V) | litres | 225 | |
| Water volume: DHW system | litres | 1.7 | |
| DHW performance V ₄₀ Economy/Normal/Comfort (EN 16147) | litres | 210 / 235 / 304 | |
| Package efficiency class: W35/55 (A+++ to G) ¹⁾ | | A+++ / A+++ | |
| Energy efficiency class DHW (A+ to F) / charge profile (EN16147) ¹⁾ | | A / XL | |

¹⁾ CTC EcoZenith is only approved for installation together with heat pumps in accordance with the EU Ecodesign Directive. The data provided is applicable together with CTC EcoPart 612M. Energy labels and data sheets can be downloaded from www.ctc.se/ecodesign



Dimensions diagram

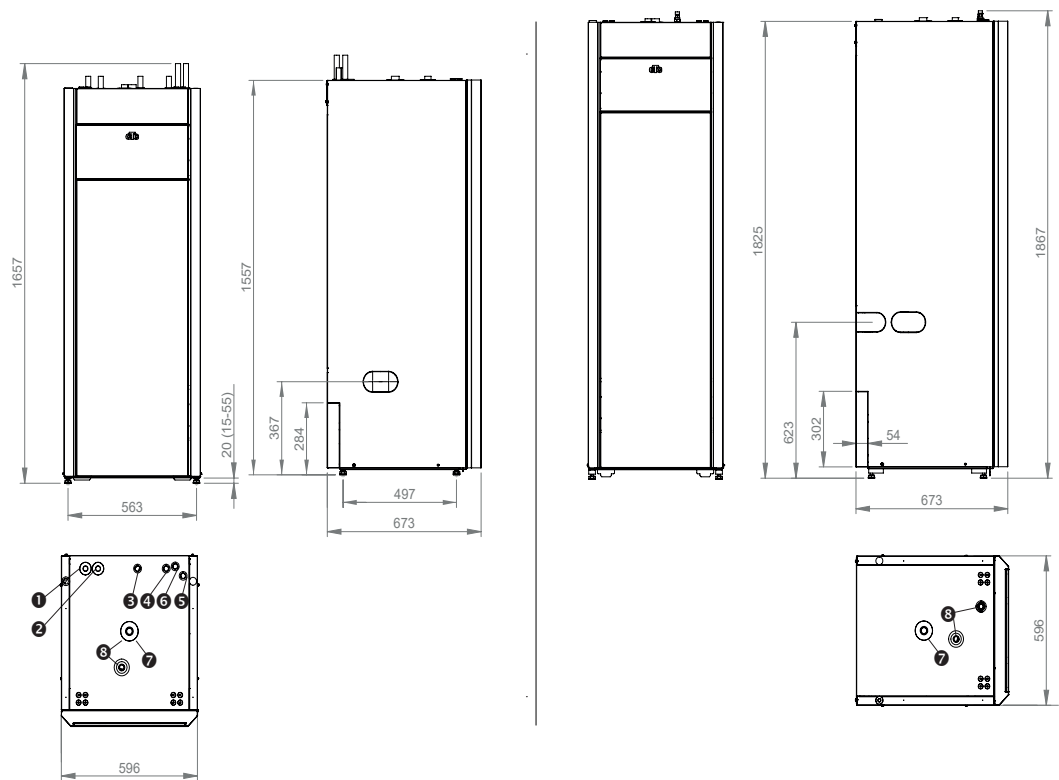

Delivery includes:

Indoor module with manual, factory-fitted charge pump, supply cable and expansion vessel.

Packaging includes:

Room sensor, outdoor sensor, automatic vent valve, filling valve, current sensor, heating circuit safety valve (2.5 bar), filter ball valve with magnet for the return heating circuit, pressure gauge, dirt filter for cold water, and drainage valve.

| Technical data 400 V | | i360 L 1N~ | i360 L 3~ |
|--|--------|-------------------------------|-----------------------------|
| CTC-no. | | 589400002 | 589400003 |
| Weight (packaged weight) | kg | 145 (172) | 145 (172) |
| Dimensions (depth x width x height) | mm | 673 x 596 x 1669 | 673 x 596 x 1669 |
| Required ceiling height | mm | 1669 | 1669 |
| K _v value – product (1Bar Δp) | | 2.6 | 2.6 |
| Sound power L _{WA} B0/W35 (EN 12102) | dB(A) | 15 | 15 |
| Electrical data, connection | | 230V 1N~ 50Hz | 230V 3~ 50Hz |
| Rated power | kW | 9.3 | 10.3 |
| Rated current (recommended fuse) | A | 41 (50) | 27 (32) |
| Max. immersion heater output at group fuse: 20/25/32/35/50/63 A | kW | 3.8 / 5.2 / 6.7 / 7.5 / 9 / 9 | 5 / 7.5 / 10 / 10 / 10 / 10 |
| Ingress Protection class (IP) | | IP X1 | IP X1 |
| Output range immersion heater (min-max) | kW | 0.3 - 9.0 | 2.5 - 10.0 |
| Max. operating pressure: Heating system (PS) | bar | 0.3/3.0 | 0.3/3.0 |
| Max. operating pressure: DHW system | bar | 10 | 10 |
| Water volume: Heating system (V) | litres | 225 | 225 |
| Water volume: DHW system | litres | 1.7 | 1.7 |
| DHW performance V ₄₀ Economy/Normal/Comfort (EN 16147) | litres | 210 / 235 / 304 | 210 / 235 / 304 |
| Package efficiency class: W35/55 (A+++ to G) ¹⁾ | | A+++ / A+++ | A+++ / A+++ |
| Energy efficiency class DHW (A+ to F) / charge profile (EN16147) ¹⁾ | | A / XL | A / XL |



info@enertech.se

+46 372 88 000

Fax: +46 372 86 155

P.O Box 309 SE-341 26 Ljungby Sweden



Compatible heat pumps

– refer to individual product sheets for more detailed information.



CTC EcoAir 406–408, 510M–622M



CTC CombiAir



CTC EcoPart 406–412, 612M–616M

Smart accessories

– supplement and simplify.

| | | CTC no.: |
|---|---|-----------|
| CTC Charge Pump 25/6.0-130 | Additional circulation pump/radiator pump | 588892301 |
| CTC Expansion Energyflex II | External control of solar/pool/DHW circulation, etc. | 589262301 |
| CTC Diverting Valve, 3-way | For interconnections in the system, e.g. pool (22 mm connection) | 583621401 |
| CTC EcoVent 25 | Exhaust air unit - Adapted for placement above the heat pump | 589701001 |
| CTC EcoComfort | A passive cooling unit that uses the borehole's cool temperature | 585920001 |
| CTC Through-flow heater 11.9 kW | INCOLOY - for areas where there are problems with high chloride levels | 589595302 |
| CTC Housing cover high | 480 mm. Hide pipe connections, etc. with a stylish housing cover | 589442301 |
| CTC Housing cover low | 146 mm. Hide pipe connections, etc. with a stylish housing cover | 589440301 |
| CTC Housing cover medium | 380 mm. Hide pipe connections, etc. with a stylish housing cover | 589441301 |
| CTC DHW button | Activates the extra hot water function, wire-bound | 582515301 |
| CTC SmartControl Gateway | Base unit able to control up to seven optional units | 588300301 |
| CTC SmartControl Repeater | Amplifies the signal between the base unit and the different accessories | 588300302 |
| CTC SmartControl Room/Humidity/CO ₂ sensor | Wired sensor that can control ventilation on demand (Base unit required) | 588300303 |
| CTC SmartControl Room/Humidity Sensor | Solar powered and wireless with rechargeable battery (Base unit required) | 588305301 |
| CTC SmartControl Room Sensor | Solar powered and wireless with rechargeable battery (Base unit required) | 588306301 |
| CTC SmartControl Multi-button | Wireless 2 mode button (Base unit required) | 588307301 |
| CTC Solar Pump Station | Compact solar pump station for solar heating | 587700001 |
| CTC Start-kit EcoSol | Start kit for connecting CTC solar control with existing solar system | 587458301 |
| CTC Current Sensor, 1-pack | For monitoring the building's main fuses (I360 L 1x230V) | 908453001 |